

DS-5

TAPE DECK SELECTOR



WARNING

To prevent fire or shock hazard, do not expose this appliance to rain or moisture.

Operator's Manual



MANUFACTURED & DISTRIBUTED BY AKAI ELECTRIC CO., LTD.
AKAI TRADING CO., LTD. AKAI AMERICA LTD.

This Akai Tape Deck Selector lets you directly connect up to 4 tape decks for tape dubbing and monitoring. You can also connect such component as a mixing amplifier, graphic equalizer or noise reduction system for various recording and playback.

PRECAUTIONS

1. Touching the plug with wet hands risks dangerous electric shocks.
Always pull out by the plug and never the cord.
2. Only let a qualified professional repair or re-assemble the equipment.
3. Never allow a child to put anything, especially metal into this equipment. Malfunction may occur.
4. If water is spilled on this equipment, disconnect and call your dealer.
5. Make sure the equipment is well ventilated and away from direct sunlight.
6. Keep away from heat (stoves, etc.) to avoid damage to the external surface and internal circuits.
7. Avoid spray-type insecticides which will damage the equipment and may ignite suddenly.
8. To avoid damaging the finish never use alcohol, paint thinner or other similar chemicals.
9. Always place the equipment on a flat and solid surface.
10. Please read this manual in its entirety and keep it handy for further reference.

CONTROLS

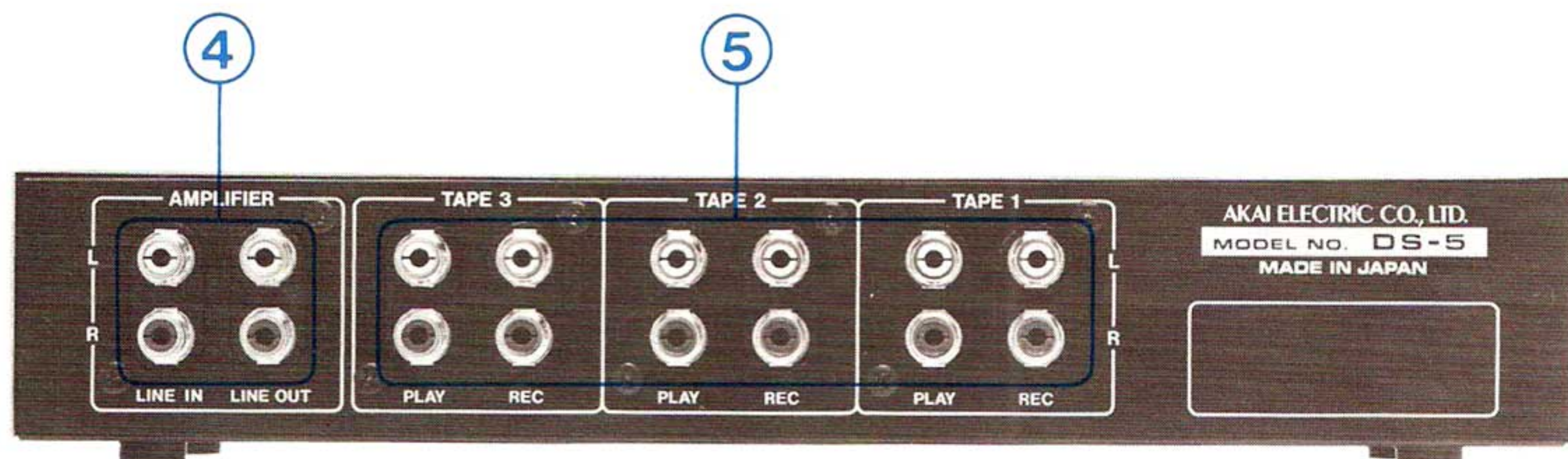
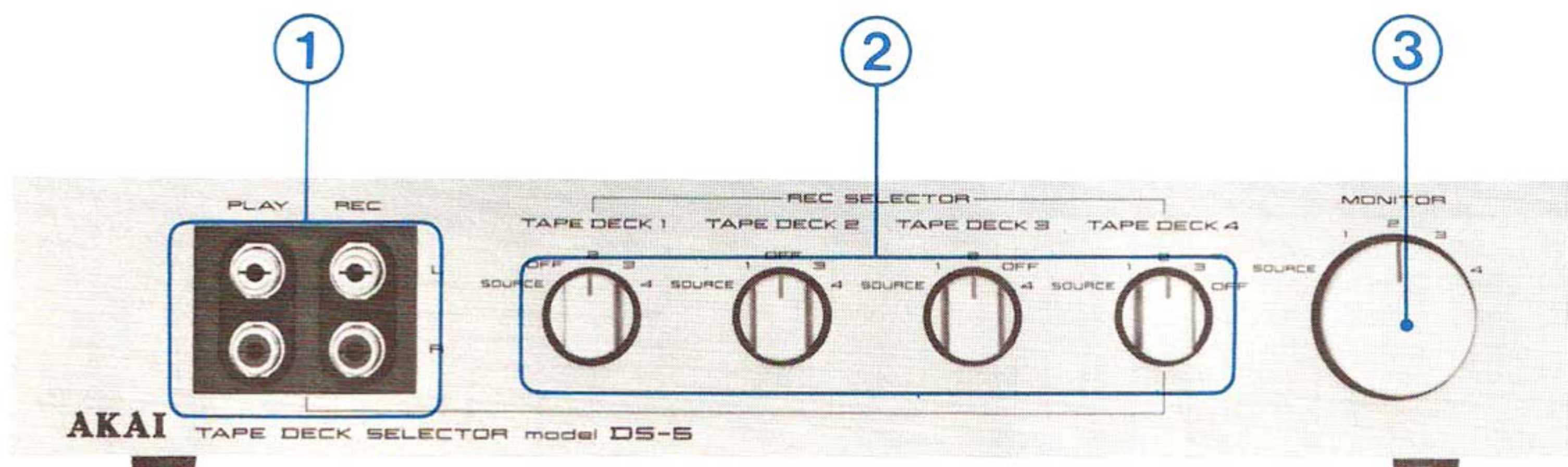

1. Tape 4 Jacks

PLAY: Connect to the output jacks (LINE OUT) of a tape deck.

REC: Connect to the input jacks (LINE IN) of a tape deck.

2. Recording (REC) SELECTOR, TAPE DECK 1 to 4.

SOURCE: Set to this position when recording from a source (tuner, turntable, etc.) connected to the amplifier.

1 to 4: When dubbing, set to the number corresponding to the tape deck in playback mode.

OFF: Set to this position when the tape deck is in playback mode for dubbing. Also set to this position when not in use.

3. MONITOR Selector

SOURCE: Set to this position to monitor signals from the source (tuner, turntable, etc.) connected to the amplifier.

* Set the Input Selector or the Tape Monitor Switch of the amplifier to Tape.

1 to 4: Set to the number corresponding to the tape deck to monitor the signals from the tape deck.

4. AMPLIFIER Jacks

LINE IN: Connect to the amplifier's REC jacks.

LINE OUT: Connect to the amplifier's PLAY jacks.

5. TAPE 1 to 3 Jacks

PLAY: Connect to the output jacks (LINE OUT) of a tape deck.

REC: Connect to the input jacks (LINE IN) of a tape deck.

When connecting a mixing amplifier, graphic equalizer or noise reduction system instead of a tape deck, connect its input jack to one of the LINE OUT jacks and its output jack to the LINE IN jacks.

CONNECTIONS

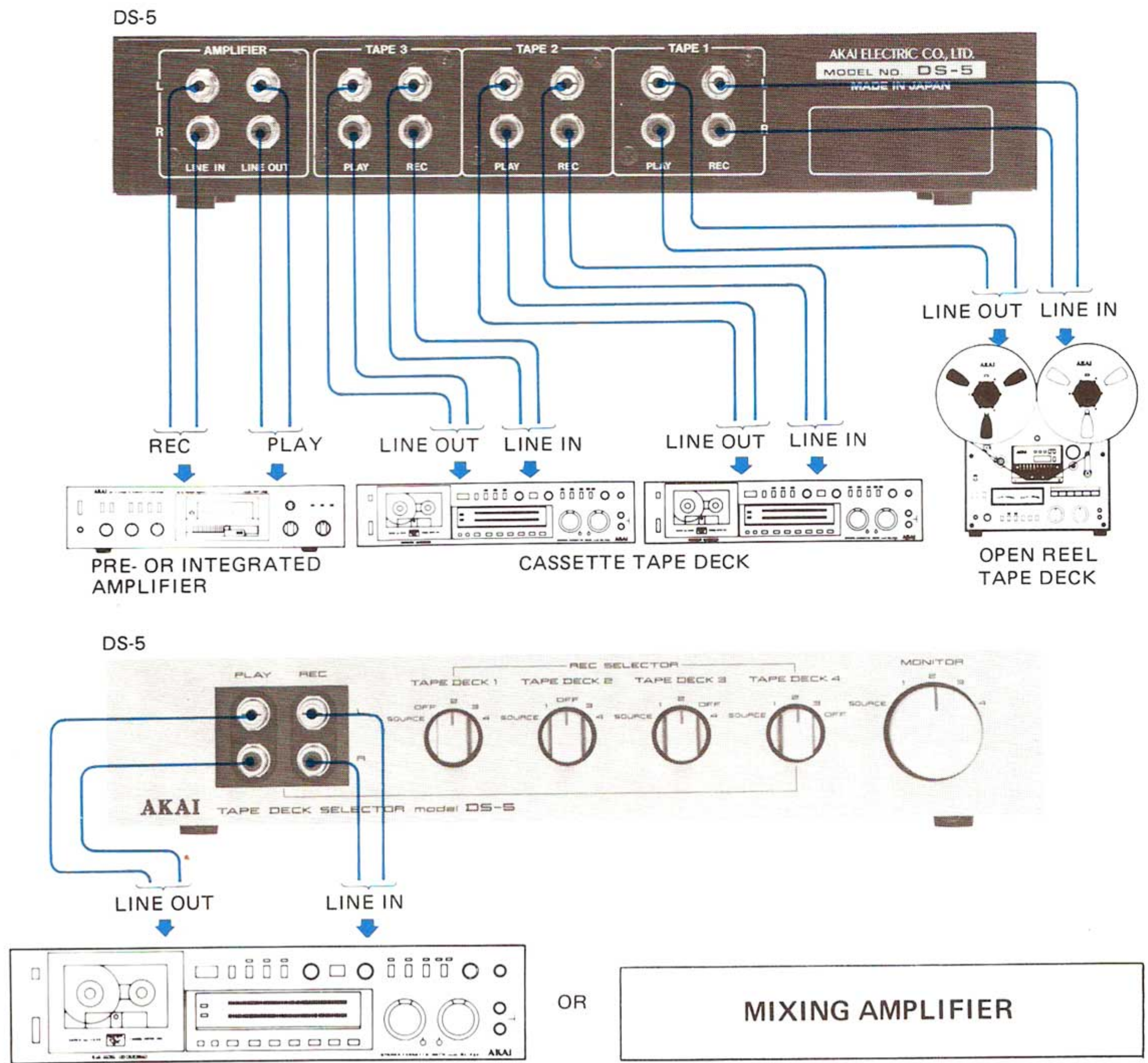

CONNECTIONS

- Turn off all the components before connecting.
- Carefully connect the components. The chance of incorrectly connecting the components is high due to the large number of connection cords.
- Do not mix-up the left and right, LINE IN and LINE OUT connections.
- Noise and distortion will result if the plugs are not clean or not properly inserted into the jacks.

CAUTION:

When connecting such accessory as a mixing amplifier, be very careful concerning the relationship between the inputs and the outputs. If a tape deck's input jacks are somehow connected to its output jacks through another component such as a mixing amplifier during recording or monitoring, oscillation may occur. This will have an adverse effect on the tape deck as well as on the other components connected to the DS-5.

OPERATIONS

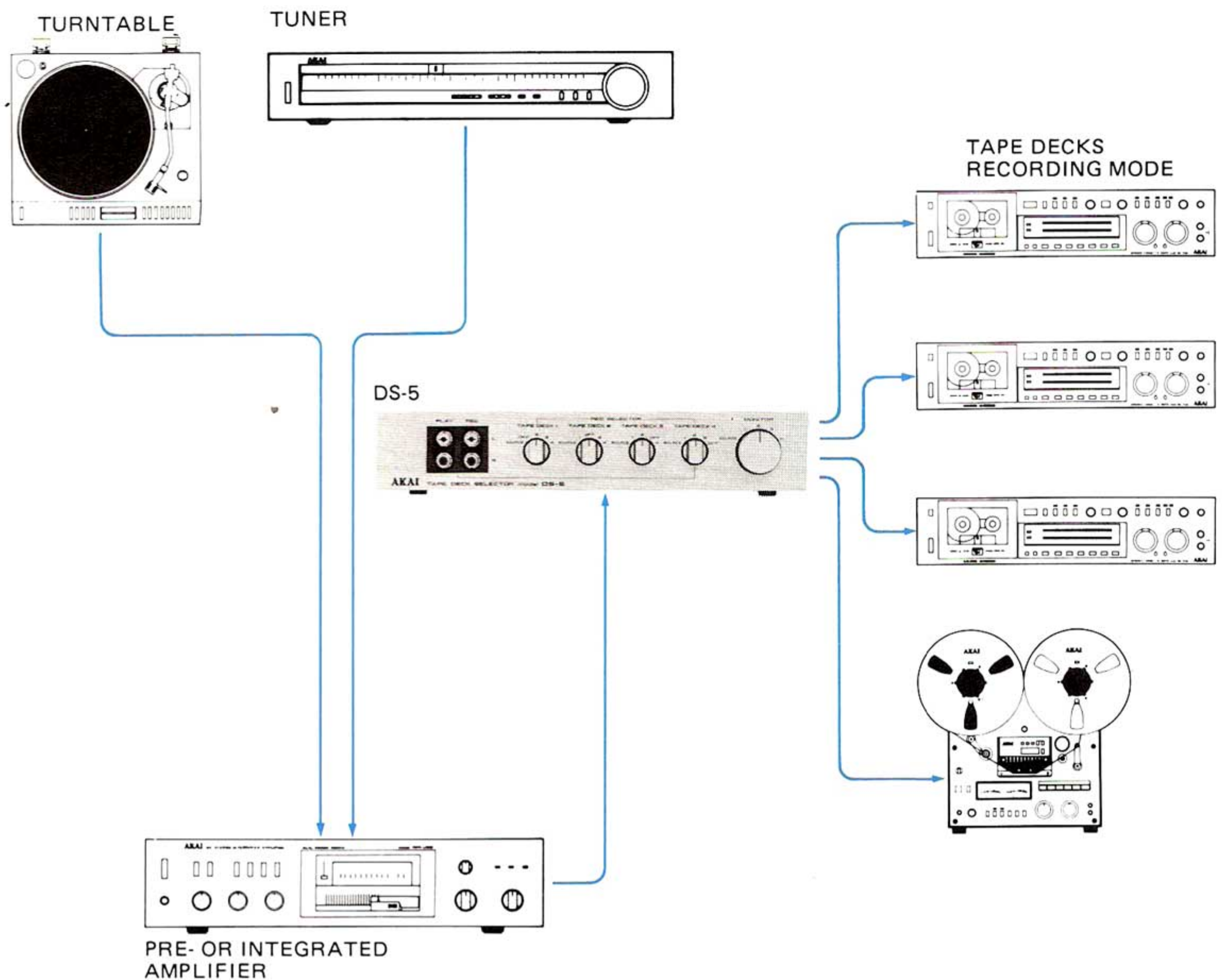

Recording from a tuner or turntable connected to the amplifier:

1. Set the Input Selector of the amplifier to Phono or Tuner. For amplifiers with a Recording Selector, set the Recording Selector to the same position as the Input Selector.
2. Set the DS-5's REC SELECTOR TAPE DECK 1 to 4 to SOURCE.
3. Set the amplifier for tape monitoring.
* Refer to its Operator's Manual.
4. Set the tape decks to recording mode.
* Refer to each component's Operator's Manual.
5. Set the MONITOR selector to monitor the signals.
* Refer to MONITORING.

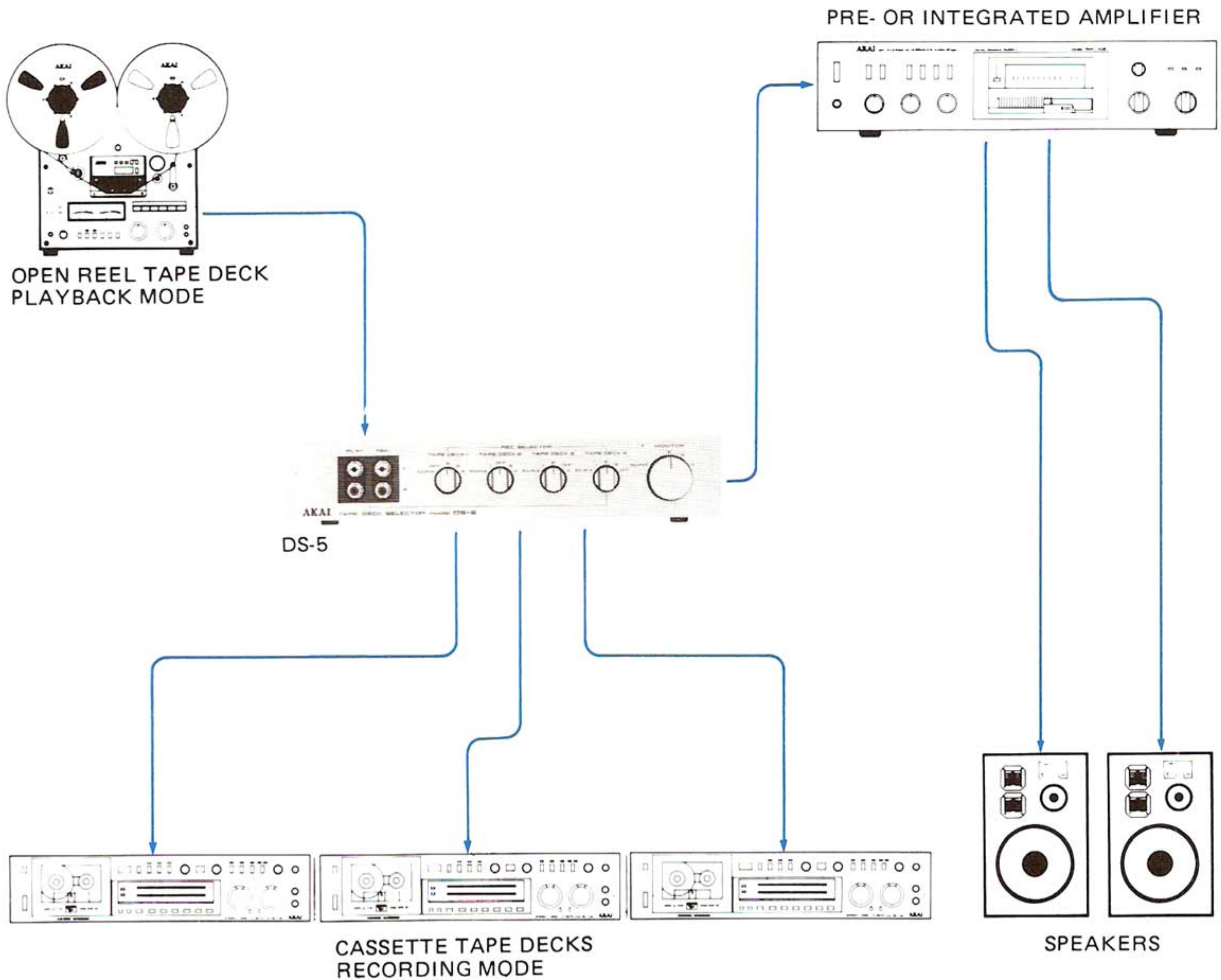

Dubbing:

Tape dubbing can be done from one tape deck to the other three tape decks or from TAPE DECK 1 to TAPE DECK 2 and TAPE DECK 3 to TAPE DECK 4.

1. Dubbing from TAPE DECK 1 to TAPE DECK 2 to 4:
 - a) Set the REC SELECTOR TAPE DECK 1 to OFF.
 - b) Set the REC SELECTOR TAPE DECK 2 to 4 to "1".

Dubbing from TAPE DECK 1 to TAPE DECK 2 and TAPE DECK 3 to TAPE DECK 4:

- a) Set the REC SELECTOR TAPE DECK 1 to OFF and the REC SELECTOR TAPE DECK 2 to "1".

- b) Set the REC SELECTOR TAPE DECK 3 to OFF and the REC SELECTOR TAPE DECK 4 to "3".
2. Set the source tape deck(s) to playback mode and the recording tape decks to recording mode.
 - * Refer to each component's Operator's Manual.
3. Set the amplifier for tape monitoring.
 - * Refer to amplifier's Operator's Manual.
4. Set the MONITOR selector to monitor the signals.
 - * Refer to MONITORING.

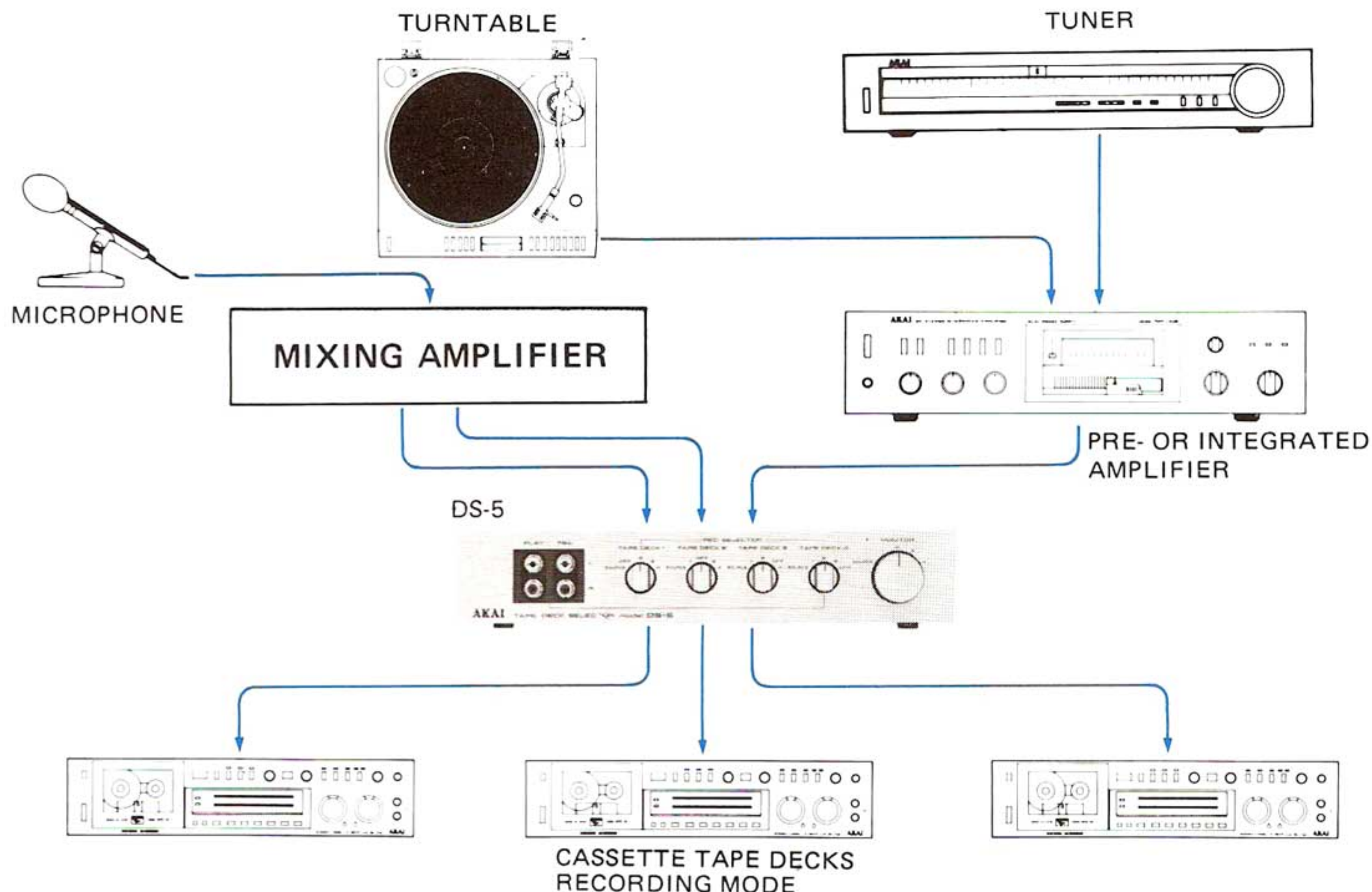

Mixing:

Recording microphone signals mixed with turntable or tuner signals by a mixing amplifier connected to the TAPE 4 jacks:

1. Set the Input Selector of the amplifier to Phono or Tuner. For amplifiers with Recording Selector, set the Recording Selector to the same position as the Input Selector.
2. Set the REC SELECTOR TAPE DECK 1 to 3

to "4".

3. Set the REC SELECTOR TAPE DECK 4 to SOURCE.
4. Set the amplifier for tape monitoring.
5. Set the tape decks to recording mode.
6. Set the MONITOR selector to monitor the signals.

MONITORING

When using 3 head tape decks for recording (independent recording, playback and erase heads), the recording being made can be compared with the source.

Example: Source: turntable connected to the amplifier.

Recording: TAPE DECK 1 to 4.

1. Set the MONITOR selector to SOURCE to monitor the source signal.
2. Set the MONITOR selector to 1, 2, 3 or 4 to

monitor the just recorded signal.

Example: Source: TAPE DECK 1 and 3
Recording: TAPE DECK 2 and 4

1. Set the MONITOR selector to 1 or 3 to monitor the source signal.
2. Set the MONITOR selector to 2 or 4 to monitor the just recorded signal.

When using 2 head tape decks for recording (recording/playback and erase heads), only the source signal can be monitored.

SPECIFICATIONS:

DIMENSIONS 280(W) x 54(H) x 120(D) mm
(10.9 x 2.1 x 4.7 inches)

WEIGHT 1.0 kg (2.2 lbs)

* For improvement purposes, specifications and design are subject to change without notice.



MANUFACTURED & DISTRIBUTED BY
AKAI ELECTRIC CO., LTD.
AKAI TRADING CO., LTD.

12-14, 2-chome, Higashi-Kojiya.
Ohta-ku, Tokyo, Japan

AKAI AMERICA, LTD.

P.O. Box 6010, 800 W. Artesia Blvd.
Compton, Calif., 90224, U.S.A.
TELEPHONE: (213) 537-3880
TELEX: 67-7494



Printed in Japan

U 560314D1 560323-01